

Profile

- Freely programmable electronic digital display for length or angular measurement
- Freely programmable via the ProToolDE programming software
- Hollow shaft, max. \varnothing 14 mm
- LCD display with 5 digits and special characters
- Digit height approx. 8 mm
- Reset, incremental measurement, offset via keyboard
- Long battery life
- Easy battery change without dismantling of the device

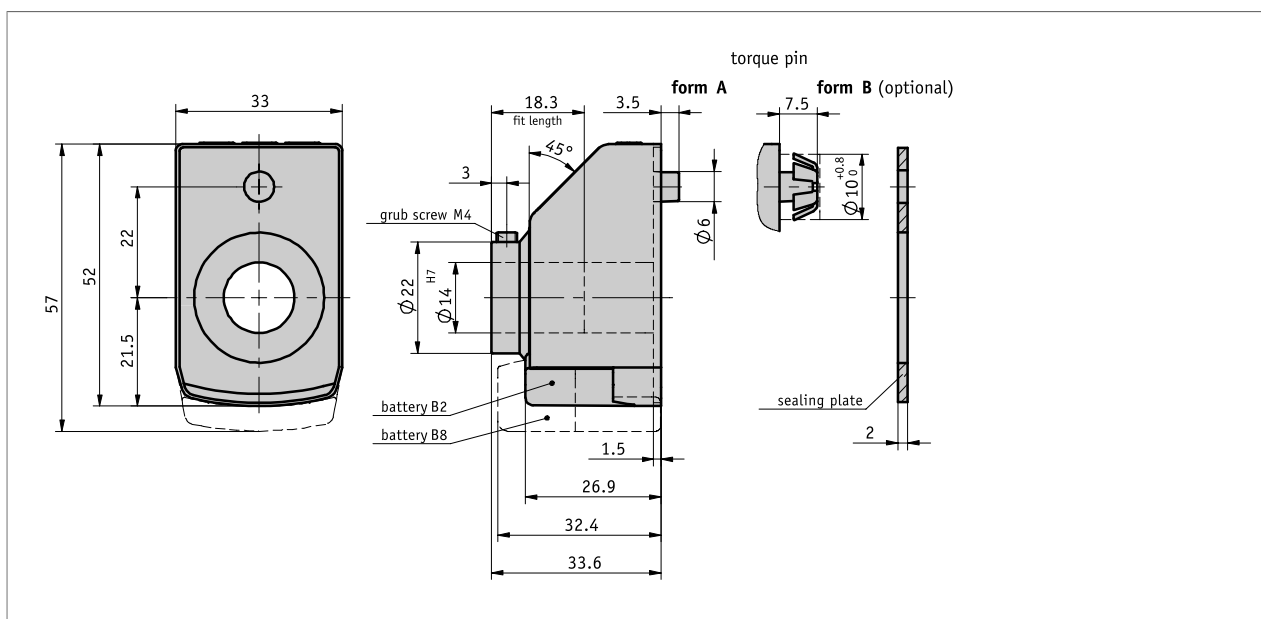

Mechanical data

Feature	Technical data	Additional information
shaft	black-finished steel (supported in friction bearings)	($\leq \varnothing$ 16H7)
Housing	plastic	
Speed		(100% duty cycle)
Weight		

Electrical data





Feature	Technical data	Additional information
Battery	lithium coin cell, 3 V, CR2032 type	~2-year service life
	lithium coin cell, 3 V, CR2477 type	~8-year service life
Display/display range	5-digit LCD 7-segment, ~8 mm height	-19999 ... 99999

Ambient conditions

Feature	Technical data	Additional information
Ambient temperature		
Storage temperature		
EMC	EN 61000-6-2	interference resistance / immission
	EN 61000-6-4	emitted interference / emission
Protection category	IP51	EN 60529
Shock resistance	300 m/s ² , 15 ms	EN 60068-2-27
Vibration resistance	100 m/s ² , 5 ... 150 Hz	EN 60068-2-6
	200 m/s ² , 100 ... 2 kHz	EN 60068-2-6

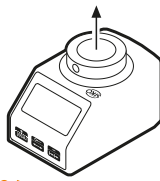
Order

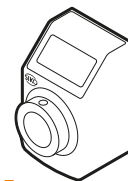
Ordering information

Mounting position		Key pad operation			Counting direction
					
02	04	D/V	K	OF	

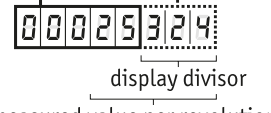
Display	Display divisor	Calculation of value displayed (example order text):												
	The indication of the measured value on the display can be influenced by means of the divisor (divider). The divisor shifts figures of the measured value into the invisible sector of the display unit. Although the figures are not displayed, they are also calculated by the electronics unit and mathematically rounded.	Measured value per revolution 25324 Display divisor 1000												
		<table border="1"> <thead> <tr> <th>Feature</th> <th>Displayed value</th> <th>Measured value</th> </tr> </thead> <tbody> <tr> <td>1st revolution</td> <td>25</td> <td>25324</td> </tr> <tr> <td>2nd revolution</td> <td>51</td> <td>50648</td> </tr> <tr> <td>3rd revolution</td> <td>76</td> <td>75972</td> </tr> </tbody> </table>	Feature	Displayed value	Measured value	1st revolution	25	25324	2nd revolution	51	50648	3rd revolution	76	75972
Feature	Displayed value	Measured value												
1st revolution	25	25324												
2nd revolution	51	50648												
3rd revolution	76	75972												

 Please note that the value displayed (=measured value per revolution / display divisor) must be at least 2!

Ordering table

Feature	Ordering data	Spezifikation	Additional information
Mounting position**	A 02 04		
Measured value per revolution**	B ... W3600 Z3600	00002 ... 90000 angle mode 0° ... 360°, resolution 0.1° angle mode -180° ... +180°, resolution 0.1°	see calculation of displayed value "only with comma position "1" "" "only with comma position "1" ""
decimal place*	C 0 1 2 3 4	0 = 00000 1 = 0000.0 2 = 000.00 3 = 00.000 4 = 0.0000	
display divisor**	D ...	1, 10, 100, 1000	see calculation of displayed value
Counting direction*	E e i	counter-clockwise ascending values clockwise ascending values	
key pad operation	F D V K OF	direct zeroing* zeroing delayed by 5 s* only incremental measurement function without function keys	

Freely programmable

Feature	Ordering data	Spezifikation	Additional information
hollow shaft/diameter	G 14	ø14 mm RH6, RH8, RH9.525, RH10, RH12	reducing bushes
	16 ...		
Color	H 0	orange RAL 2004	
	S	black RAL 9005	
Battery	I B2	~2-year service life	observe technical drawing
	B8	~8-year service life	

* Programmable via ProTool DE programming software

Order key



Scope of delivery:

DE04, Installation Instructions



Accessories you can find:

clamping plate KPE04
programming software ProTool DE
adapter sleeve RH04

www.siko-global.com
www.siko-global.com
www.siko-global.com