

Profile

- Robust and economic plastic handwheel
- Hub made of zinc-coated steel for high stability and easy shaft mounting
- Various hub versions
- With thread for mounting a turning handle (see accessories)

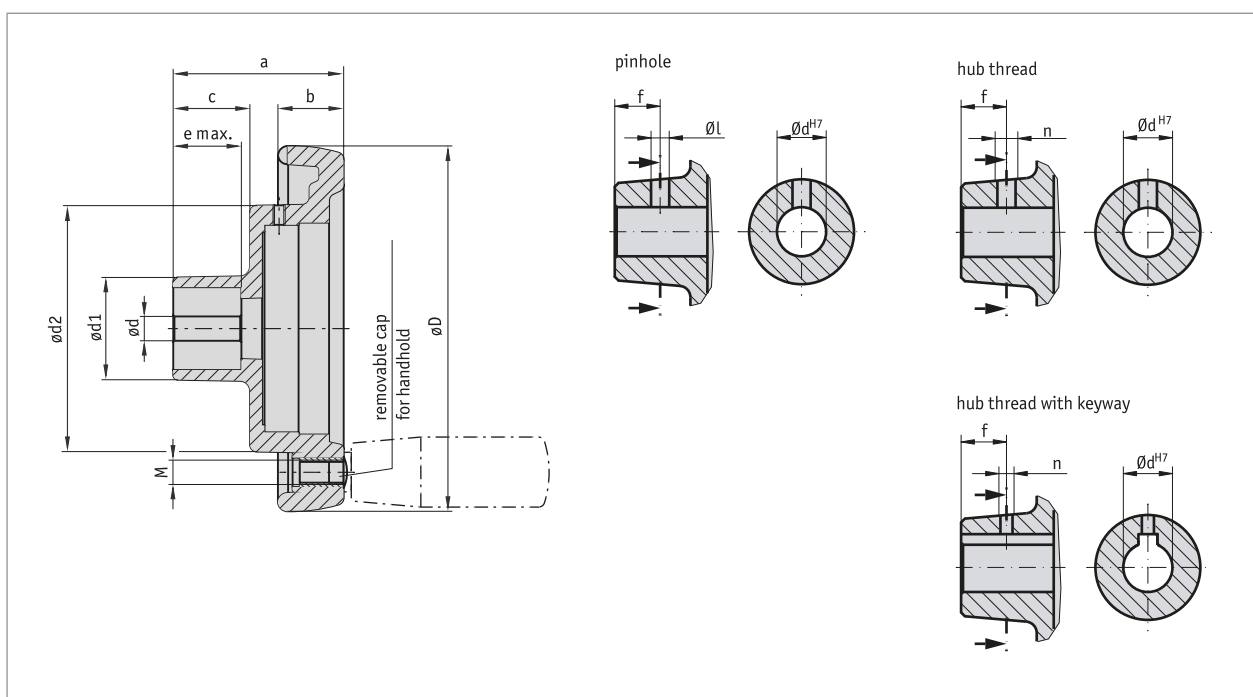

Mechanical data

Feature	Technical data	Additional information
Material	plastic	hub of hot-dip steel
Weight	0.16 kg	KHB9

■ Dimensions

øD	ødv	ødx	ød1	ød2	a	b	c	e	GfG	Suitable for
87	5.8	16	32	63	54	17	21	20	M6	S50/1

ødv = d pre-drilled; ødv = d max.; GfG = thread for handle

■ special processing

Handwheel type	KHB9				
Bore dH7	6 ... 8	9, 10	11, 12	13, 14	15, 16
Groove width with keyway JS9		3	4		
Pin hole	3.8/8	3.8/8	3.8/8	4.8/8	
Hub thread without keyway JS9	M4/8	M4/8	M4/8	M6/8	
Hub thread with keyway JS9		M3/8	M3/8		

Highlights in orange are order features.

Order

■ Ordering table

Feature	Ordering data	Spezifikation	Additional information
Bore diameter	A 5.8 ...	prebored 06 ... 16 mm, in steps of 1 mm	see Table of dimensions, maximum value ødx
feather key groove	B OP JS9	without feather key groove Light fit	according to DIN 6885/1 T1
Pinhole	C OS ...	without pin hole Diameter "øL"/dimension "f" (e.g., 3.8/12)" others on request	see Table of dimensions; value GfG
hub thread	D ONG ...	without hub thread Thread "n"/dimension "f" (e.g., M4/12)" others on request	"see table Special processing, depending on the handwheel type, only if pin hole is "OS""
position indicator	E PM PS	Position indicator mounted Separate position indicator	separate ordering of a position indicator required! separate ordering of a position indicator required!
tapered hub	F OAN	without twisted hub others on request	

■ Order key

KHB9 - - - - - -



Scope of delivery:

KHB9



Accessories you can find:

Analog position indicator S50/1
End plate AD
Handwheel holder BGD
Handwheel holder BGF
Handwheel holder UG
Handwheel holder ZGD

www.siko-global.com
www.siko-global.com
www.siko-global.com
www.siko-global.com
www.siko-global.com
www.siko-global.com