

### Profile

- analog position indicator
- Measured value acquisition based on the gravity principle
- High stability thanks to doubly supported pointer shaft
- Very robust, glass-fiber reinforced plastic housing
- Wide range of gear ratios
- Special scales, also for small numbers of pieces
- Dustproof, oil-filled or waterproof versions

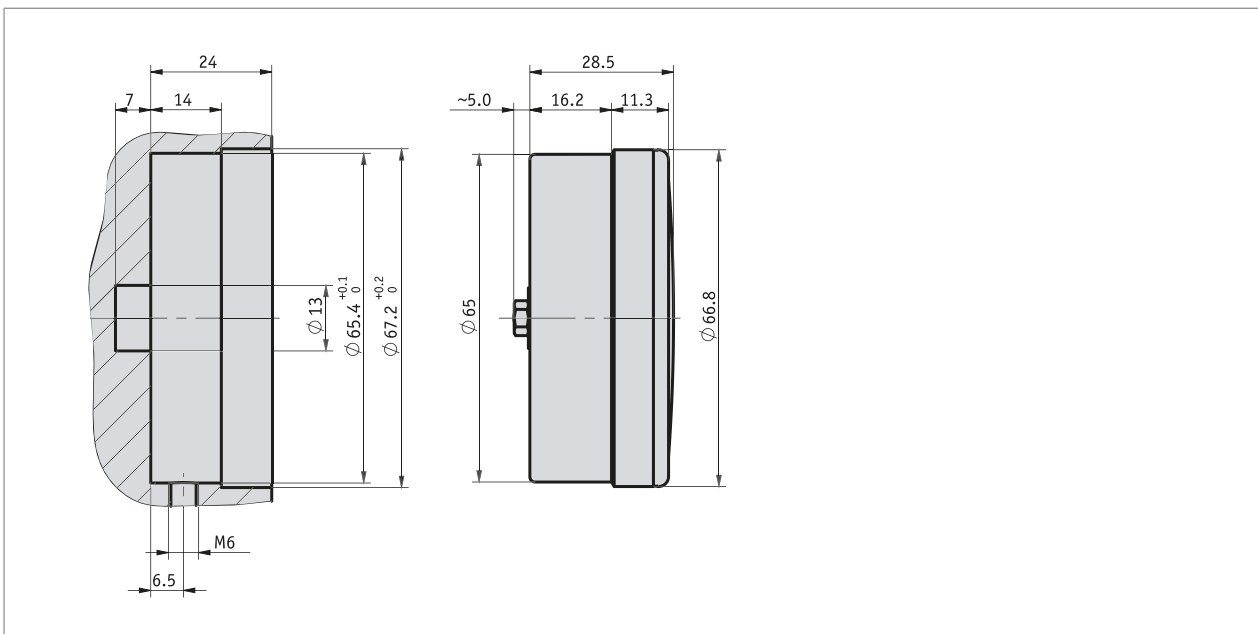

### Mechanical data

Feature	Technical data	Additional information
Housing	reinforced plastic	
Weight	0.1 kg	N, W design
	0.1 kg	NL design

### Order

#### ■ Ordering table

Feature	Ordering data	Spezifikation	Additional information
version	A N P W	dust-proof oil-filled waterproof	
Gear ratio	B ...	1, 2, 3, 6, 10, 12, 15, 18, 20, 24, 30, 36, 48, 50, 60, 72, 84, 96, 100 others on request	
Sense of rotation	C i e	clockwise ascending values counter-clockwise ascending values	
Pointer	D 1	red with transmission	

# Analog position indicator S70/1

Individually usable for third-party handwheels

Feature	Ordering data	Spezifikation	Additional information	
	2	red with transmission + black 1:1		
scale	E	N...	normal scale	related to the transformation ratio
		VK...	special scale	customer-specific, no VK for first production
multi-color scale	F	C1	1-colored	
		C2	2-colored	
		C3	3-colored	

## ■ Order key



 **Scope of delivery:**  
S70/1