

Absolute encoder WV58M

Absolute angle encoder based on magnetic sensing technology for difficult operating conditions such as humidity, vibration, shock and temperature fluctuation.



SIKO GmbH

Address
Weihermattenweg 2
79256 Buchenbach

Telephone
+49 7661 394-0

Fax
+49 7661 394-388

eMail
info@siko.de
Internet
www.siko.de



Features:

- Robust contactless 12+12 bit scanning
- Electronic gear
- Standard SSI output; RS485 and fieldbus optional
- Very compact design
- Cap made of shielded sheet steel

Feature	Order text		Additional information
Interface/protocol	S6/04	A	RS422/SSI
	S3/06		RS485/SIKONETZ-3
	PB		Profibus-DP
	CAN		CANopen
Connection type	E2	B	pin contact
	E4		pin contact
	E12		pin + socket contact
Steps per revolution	1024	C	10 Bit
	4096		12 Bit
Number of revolution	1	D	singleturn
	4096		multiturn
Shaft diameter x length	6x10	E	ød x L
	10x20		ød x L
Environmental conditions	S	F	
	E		extended (condensation)

Your ordering: WV58M - A - B - C - D - E - F

Absolute encoder WV58M

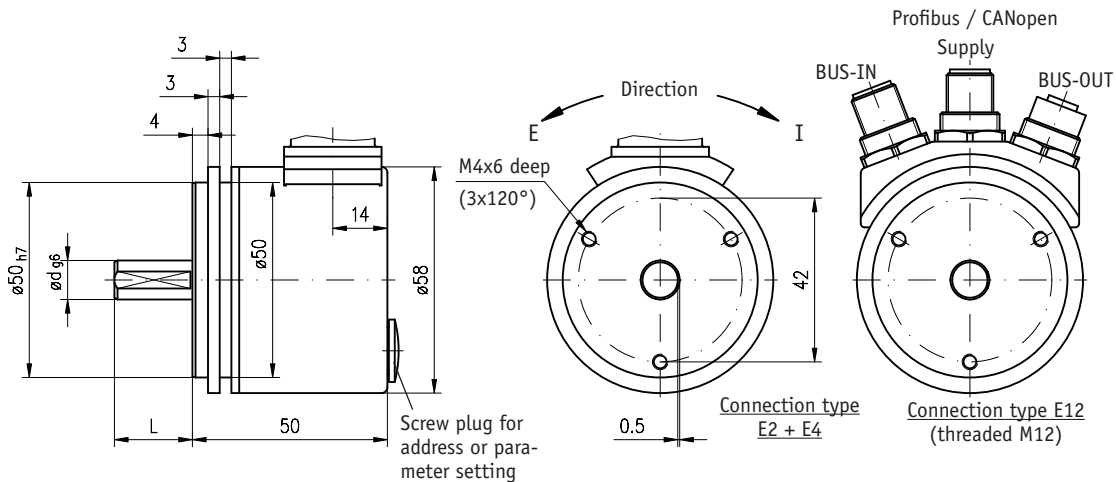

Pin designation E2; interface S6/04

Pin	1	2	3	4	5	6	7-9	10	11	12
Signal	GND	+UB	Cycle +	Cycle -	Data +	Data -	N.C.	RS485 DÜA	RS485 GND (internal)	RS485 DÜB

Pin designation E4; interface S6/04

Pin	A	B	C	D	E	F	H	J	K	G, L, M
Signal	Data -	Data +	Cycle -	Cycle +	+UB	GND	RS485 DÜA	RS485 GND (internal)	RS485 DÜB	N.C.

Pin designation E4; interface S3/06

Pin	1	2	3	4	5	6	7
Signal	DÜA	DÜB	GND	N.C.	+UB	N.C.	N.C.

Pin designation E12; interface PB

Pin	1	2	3	4	5
Profibus-IN	N.C.	BUS-A	N.C.	BUS-B	N.C.
Profibus-OUT	VP (2P5)	BUS-A	DGND (2M)	BUS-B	screen

Pin designation E12; interface CAN

Pin	1	2	3	4	5
CANopen-IN	N.C.	N.C.	CAN_GND	CAN_H	CAN_L
CANopen-OUT	N.C.	N.C.	CAN_GND	CAN_H	CAN_L

Pin designation E12; supply

Pin	1	2	3	4
Supply	+UB	N.C.	GND	N.C.

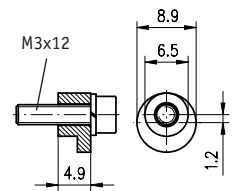

Servo clamp SK

(included in the package unit are: each 1x fastening eccentric, lock washer and cheese-head screw with hexagon socket)

Technical data

Mechanical data:

Type of protection	IP65
Speed max.	6000min ⁻¹
Rotor moment of inertia	ca. 5x10 ⁻⁶ kgm ²
Starting torque	≤ 0,01Nm
Load capacity of shaft	radial 80N, axial 40N
Weight	ca. 0,4kg
Working temperature	-20°C ... +100°C
Storage temperature	-30°C ... +100°C
Shaft	stainless steel
Flange/housing	aluminium / steel
Shock resistance	50g / 11ms
Vibration resistance	10g / 5...150Hz

Additional information

Elektrical data:

	SIKONETZ / SSI	CANopen	Profibus-DP
Operating voltage	+10VDC ... +30VDC	+10VDC ... +30VDC	+10VDC ... +30VDC
Output driver	RS485 / RS422	CAN High-Speed acc. to ISO/DIS 11898	RS485
Power consumption without load (typ.)	ca. 0.4W (SIKONETZ-3); ca. 0.9W (SSI)	< 1.1W	< 1.1W
SSI clock speed	min. 65kHz / max. 1MHz	---	---
Baud rate (kbit/s)	SIKONETZ: 19.2	125; 250; 500; 1000	9.6; 19.2; 93.75; 187.5; 500; 1500; 3000; 6000; 12000
Short-circuit proof outputs	yes	(in case of short-circuit, output/output or output/GND)	
Polarity protection on UB	yes		
Certification	CE	according to EN 61000-6-2, EN 61000-6-4	

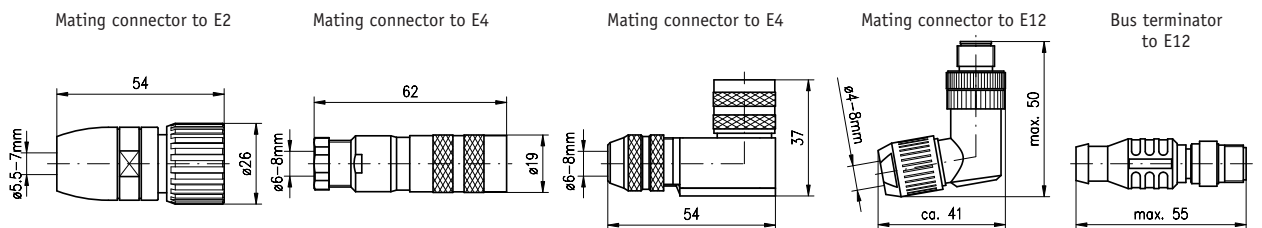

Accessory	Part No.	Description	Part No.	Description	Part No.	Description
	81935	Mating connector E2	12 pins circular cabel connector	82804	Mating con. E12 Profibus IN	5 pins angle cabel connector
	76572	Mating connector E4	12 pins circular cabel connector	82805	Mating con. E12 Profibus OUT	5 pins angle cabel connector
	77087	Mating connector E4	7 pins circular cabel connector	83006	Mating con. E12 CANopen IN	5 pins angle cabel connector
	79666	Mating connector E4	12 pins angle cabel connector	83007	Mating con. E12 CANopen OUT	5 pins angle cabel connector
	79665	Mating connector E4	7 pins angle cabel connector	82816	Bus terminator Profibus	5 pins straight cabel connector
	83091	Mating con. E12 (supply)	4 pins angle cabel connector	82815	Bus terminator CANopen	5 pins straight cabel connector
	KV-...	Cable prolagation	(to E2 or E4)	SK	Servo clamp	
	AK18	Flexible coupling				